

wideye™

liberating communications

# Quick Start User Guide

for SABRE™ I

Rev 5.0

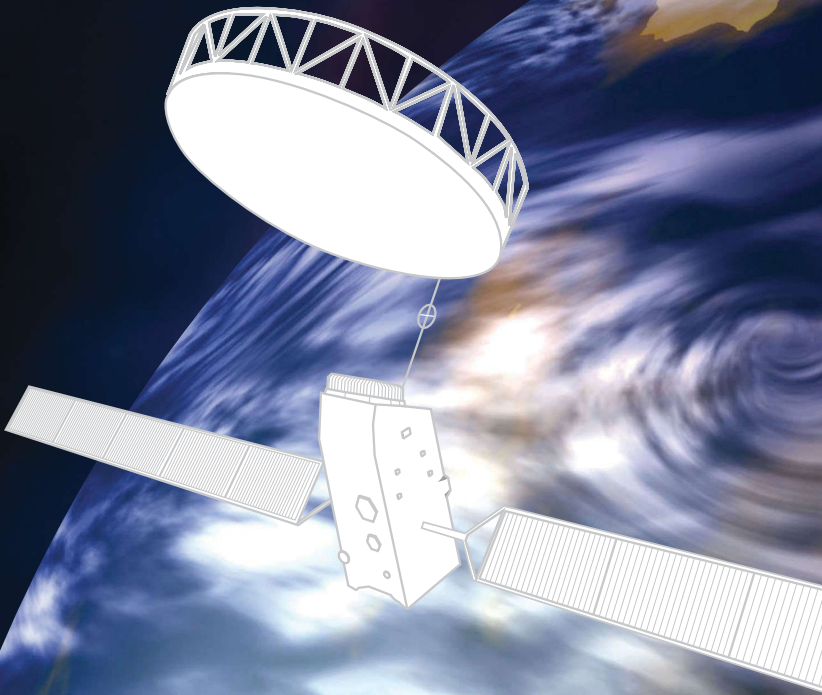

# 1 Removing and Inserting Battery Door

## 1.1 Removing the battery door

- I. Place your thumbs on the battery door as shown.
- II. Push the battery door outwards in the direction shown.

Battery door



## 1.2 Inserting the battery door

- I. Align the battery door with the guiding rail as shown.
- II. Make a slight twist to the battery door with your thumb to allow the rib (part A) to slide along the guiding rail while pushing it inwards as shown.

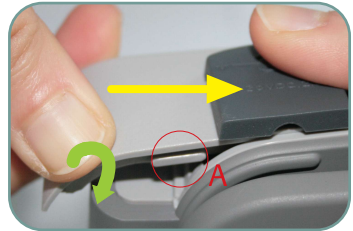

# 2 Inserting SIM card and Battery

## 2.1 Inserting the SIM Card

- I. Insert the SIM card supplied by your service provider (gold-contacts facing left as shown in the below figure) into the SIM slot.
- II. Ensure the SIM card is inserted in the position as shown.  
(To remove SIM card, press on the SIM card and remove from the slot.)

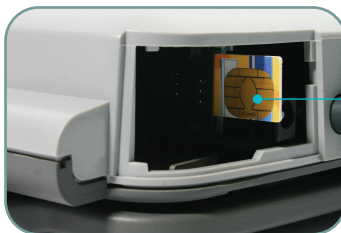

SIM Card

## 2.2 Inserting the Battery

- I. Insert the battery in the direction as shown.
- II. Slide in the battery door and ensure that it is locked into position.

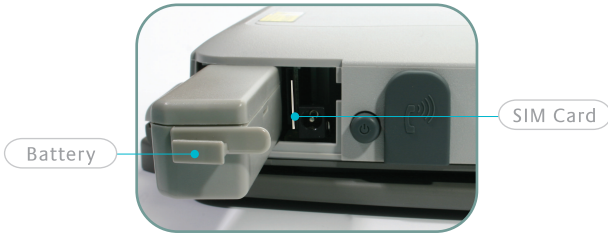

## 2.3 Charging the Battery

- I. Insert the AC/DC Power Adapter connector into the Power socket.
- II. Switch on the mains power.
- III. Do not remove the battery from the SABRE™ I during charging.

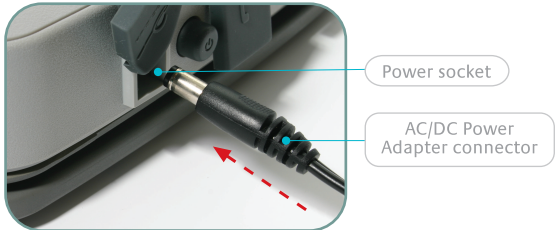

### Note:

It takes approximately 3 hours to fully charge the battery.

The charging time will be longer when SABRE™ I is switched ON while the battery is undergoing charging.

 An icon to show that the Primary Battery of SABRE™ I has completed charging while SABRE™ I is non-operational (switched off).

 An icon to show that the Primary Battery of SABRE™ I is undergoing charging while the SABRE™ I is non-operational (switched off).

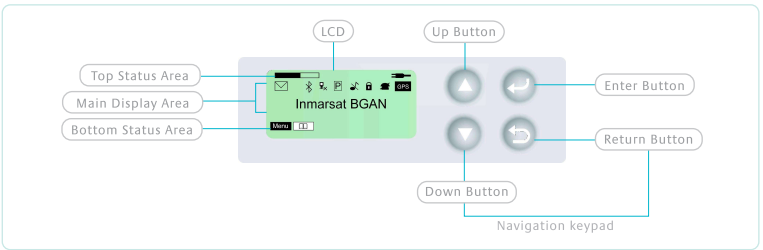

LCD Screen

## 3 Powering Up and Registering to Network

### 3.1 Powering Up

- I. Press and hold the On/Off switch for at least 3 seconds.
- II. The LCD display will show the Introductory screen.

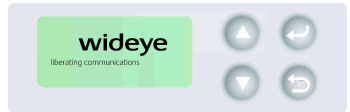

### 3.2 Terminal and SIM PINs (4 to 8 digits)

This process is applicable when the PINs are enabled. (The SABRE™ I comes with the PINs disabled at default.)

- I. For PINs entry during Power Up, refer to Chapter 3, Section 3.6.2
- II. For PINs setup, refer to Chapter 4, Section 4.6.1





### 3.3 GPS Fix

- I. For first time use, SABRE™ I needs to acquire the GPS coordinates. Go to an outdoor location and place the SABRE™ I flat with the cover facing upwards to the sky. The terminal shall perform the GPS acquisition automatically.
- II. When acquisition is done, the LCD display will show New GPS fix for 2 seconds.
- III. LCD will indicate the new estimated azimuth direction and elevation angle in which the antenna should point. A **GPS** indicator will be displayed on the Top Right corner of the LCD display to indicate that New GPS coordinates are in use.
- IV. For subsequent use, the SABRE™ I will not acquire a new GPS, it will prompt the user if the previously stored GPS coordinates should be used.

To use the stored GPS coordinates, use the Up/Down buttons to select Yes and press ENTER. A **GPS** indicator will indicate the use of stored GPS coordinates.

To re-acquire a new GPS, select No and press ENTER. The SABRE™ I terminal will repeat Step I to III.

- V. Press the ENTER button and the LCD will show the signal strength bar.

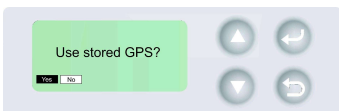
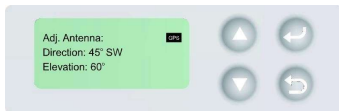
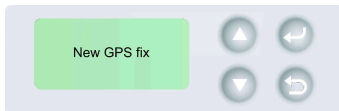
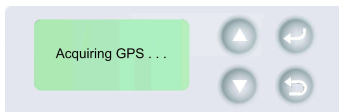

### 3.4 Antenna Pointing

- I. SABRE™ I is now in Antenna Pointing state.
- II. To obtain the maximum possible signal strength, adjust the antenna by turning and tilting it. For an acceptable service to commence, a signal strength of minimum 45 dBHz is required. Press ENTER when the maximum possible signal strength is obtained.



III. SABRE™ I will start registration with the network.

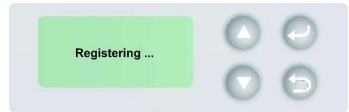

IV. When registration is successful, the service provider's name will be displayed.

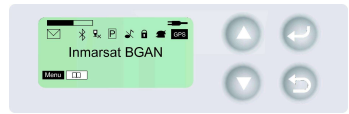

## 4 Making Phone Calls

### 4.1 Using Corded Analog Handset



I. Connect the Corded Analog Handset to SABRE™ I via (RJ11 phone) port.

II. Making phone calls directly –

a) Corded Analog Handset: Press the  to listen dial-tone before dialing and dial the calling party number in the following format; <00><Country Code><Telephone Number><#>.

## 5 Making Data Connection with SABRE™ I - Router Mode:

(note that the default mode is BRIDGE mode, refer to User Guide for setup and configuration)

### 5.1 Change to Router mode:

- I. From the LCD, use the Up/Down buttons to select **Menu > Settings > Interfaces > Ethernet > Connectivity > Router Mode** and Press ENTER.
- II. Use the Up/Down buttons to select Enable and press ENTER.
- III. Setup your PC to get IP address dynamically.

### 5.2 Activate a Data Connection:

- I. From the LCD, use the Up/Down buttons to select **Menu > Settings > Interfaces > Ethernet > Connectivity > Router Mode** and Press ENTER.
- II. Use the Up/Down buttons to select **Options > Automatic** and Press ENTER if you need an automatic Data connection after reboot.
- III. Select **Options > Manual** if you want to make the connection manually at the time you need it.
- IV. Use **Connect** or **Disconnect** to activate or deactivate a data connection respectively.
- V. If **Options > Automatic** is selected, unplugging and re-plugging the Ethernet cable will also activate the Data connection.

## 6 Activating SABRE™ I Web Console

- I. Insert the SIM card and switch on the SABRE™ I terminal.
- II. Connect the RJ45 Ethernet cable from the SABRE™ I terminal to the PC.
- III. When the connection has been established, open the web browser (for example: Internet Explorer) and type **http://192.168.1.35** in the Address field.
- IV. The User name and Password window will appear. The default User name is **admin** and Password is **wideye**. Click OK after entering the User name and Password.

**Note:**

For firmware version R12.0.5 and earlier, the default user name is **sabre1** and the password is **wideye**.

- V. The SABRE™ I Web Console will open, if required, proceed with acquiring GPS, antenna pointing and registration to the network.
- VI. Upon registration, proceed with normal operation.



Part Number: 74B00110150